

# LoPro-<sup>TM</sup>STC

Sound Rated Vision Lite  
and Glazing Assembly



**Anemostat**<sup>®</sup>  
[www.anemostat.com](http://www.anemostat.com)

1220 Watson Center Road • Carson, CA 90745  
Tel: (310) 835-7500 • Fax: (310) 835-0448  
E-mail: [door@anemostat.com](mailto:door@anemostat.com)

## LoPro-STC Assembly

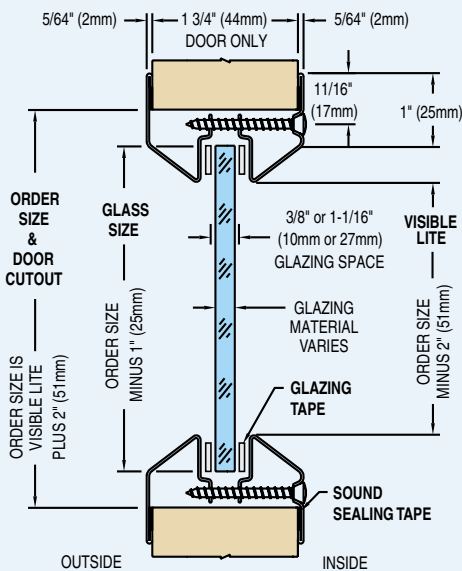
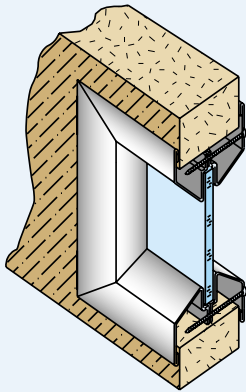

■ For use in Sound Rated Wood or Metal Doors

■ **TESTED in ACCORDANCE WITH:**  
ASTM E90-09 and ASTM E2235-04.  
STC measurements determined in accordance with ASTM E413-04.

**Testing conducted at:**

Western Electro - Acoustic Laboratory  
Santa Clarita, CA.

■ **TESTED SIZE:** 24" x 36" (610mm x 914mm)

■ **FIRE RATINGS:** See Glazing Product Technical Data Sheets at [www.anemostat.com](http://www.anemostat.com)



1220 Watson Center Road • Carson, CA 90745  
Tel: (310) 835-7500 • Fax: (310) 835-0448  
E-mail: [door@anemostat.com](mailto:door@anemostat.com)

## LoPro AA1

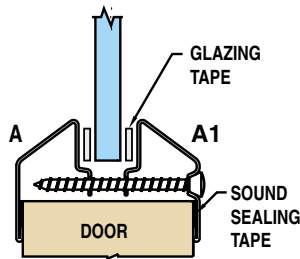

Fire/Safety Rated Glazing

## STC - 38

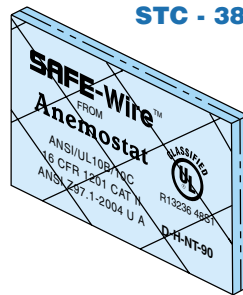

### 1/4" SAFE-Wire

- Fire Rated up to 90 min.
- Category II Safety Rated

## LoPro BB1

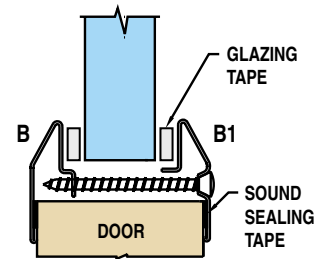

Fire/Safety Rated Glazing

## STC - 42

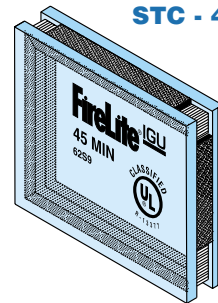

### 1" FireLite Plus IGU

- Fire Rated up to 180 min.
- Category II Safety Rated

## STC - 35

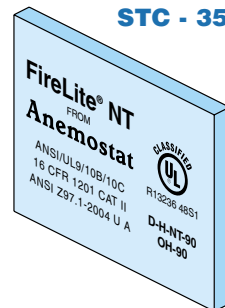

### 3/16" FireLite NT

- Fire Rated up to 180 min.
- Category II Safety Rated

## STC - 41



### 7/8" Pyrostop 60-101 23mm

- Fire Rated up to 60 min.
- Category II Safety Rated

Safety Rated

## STC - 38

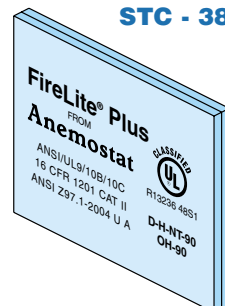

### 5/16" FireLite Plus

- Fire Rated up to 180 min.
- Category II Safety Rated

## STC - 42

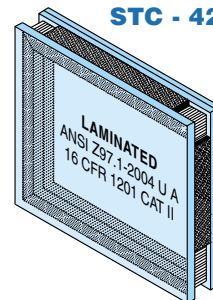

### 1" Laminated IGU

- Category II Rated
- 5/16" Laminated and 3/16" Tempered

## STC - 35

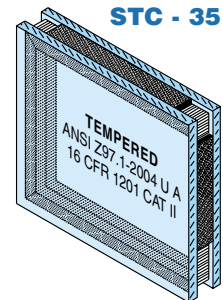

### 1" Tempered IGU

- Category II Rated
- 1/4" Tempered and 1/4" Tempered